

Careline Personal Alarm

My Amie Pendant

Installation Guide



01553 616200
careline-cs.org.uk



Borough Council of
King's Lynn &
West Norfolk



Welcome to Careline

Dear Customer,

In order to setup your new MyAmie Pendant, please follow the instructions below. Should you have any questions or require any assistance, please do not hesitate to get in touch on 01553 616200 and we will be happy to help.

Step 1

Press and hold down the green cancel button on the Careline Alarm Base Unit until it beeps for the second time (approx. 5 seconds). The Base Unit will say 'programming mode' and the red alarm button will flash slowly.

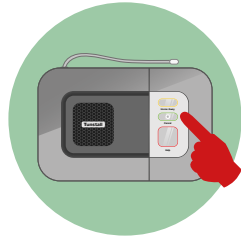

Step 2

Press and hold the green button again until a beep is heard, and then release it. The red help button on the unit will be flashing rapidly and it will say 'registration mode'.

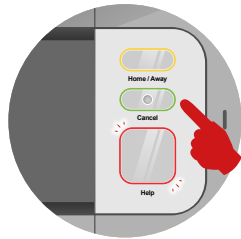

Step 3

On your new MyAmie Pendant, press the red button. The unit will acknowledge that it has been programmed by a high-pitched beep.

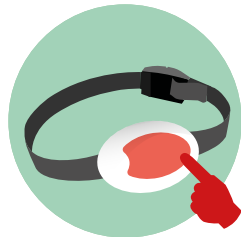

Step 4

Press the green cancel button quickly on the Careline Alarm Base Unit to exit the programming mode.

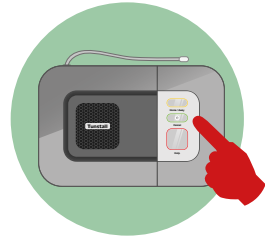

Step 5

Press the red button on the MyAmie Pendant to check that it now activates the Careline Alarm Base Unit. Please allow the alarm to dial through to the Monitoring Centre. When they answer, inform them that you are testing your new MyAmie Pendant. The call centre may advise you to do a range test. To do this, go to the furthest point of your property or garden and then retest. The pendant should work up to 50m from the base unit, depending on the thickness of your walls.

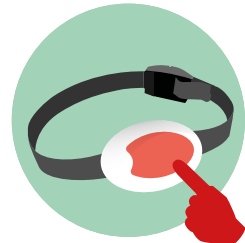

Step 6

Please return your old pendant in the pre-paid envelope that is enclosed. It can be returned to any post office.

Kind regards,
The Careline Community Service Team



Careline

COMMUNITY SERVICE

01553 616200
careline-cs.org.uk



Careline
COMMUNITY SERVICE

Borough Council of
King's Lynn &
West Norfolk

